

Waterproof switches

INT-1139P Series 8.2×8.2mm, Round case, Radial type



- **Features** : IP67 dust & water resistance
- **Applications** : Home appliances or Industrial equipments used around water
- **Specifications** :

Rating	DC 12V 50mA
Contact resistance	100mΩ Max.
Travel (mm)	0.25+0.2/-0.1

► Part list

Part No.	Length (mm)	Operating force	Side terminals	Stem color	Life	QTY per pack (Tape)
INT-1139P128A	12.8	230±40gf	Exposed	Gray	100,000 Cycles Min.	800
INT-1139P13A	13.0			Yellow		
INT-1139P128B	12.8	Ivory				
INT-1139P13B	13.0	Red				

► Drawing

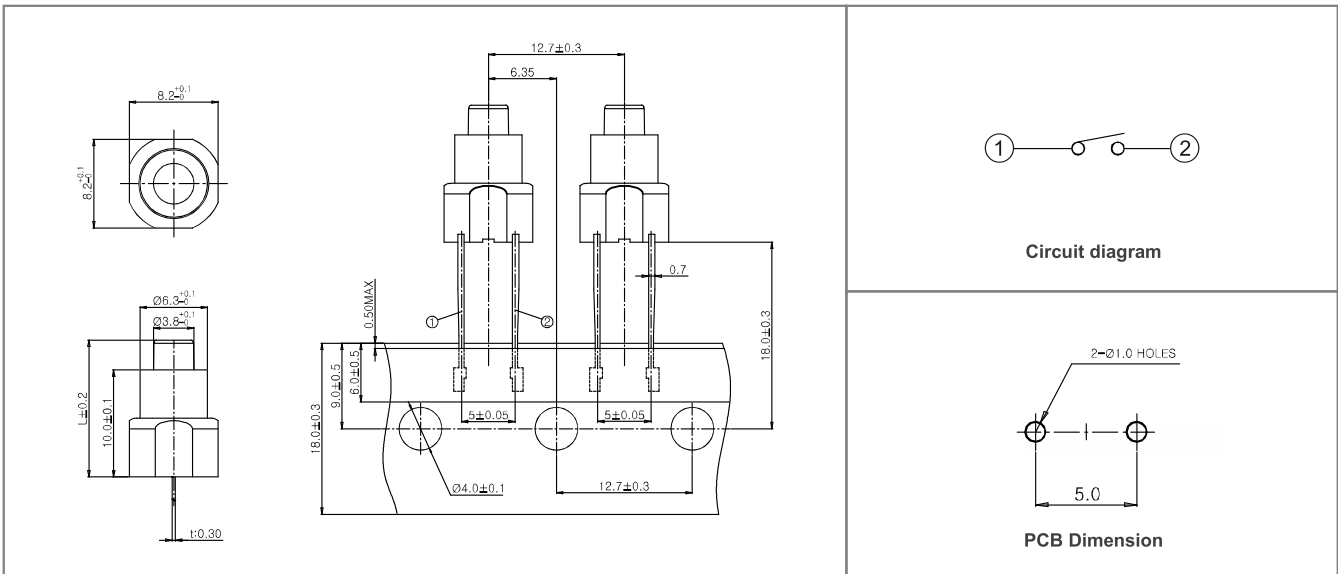

TACT Switches
 PUSH Switches
 HOOK Switches
 DETECTOR Switches
 SLIDE Switches
 ROTARY Potentiometers
 LEVER Switches
 ROTARY Switches
 CAPS