

Waterproof switches

INT-1129BM Series

6.2x6.2mm, Ø2.2mm Stem, Metal cover, Through hole type

Features : IP67 dust & water resistance

Applications : Home appliances or Industrial equipments
used around water

Specifications :

Rating	DC 12V 50mA
Contact resistance	100mΩ Max.
Travel (mm)	0.3±0.1



Model list :

Model No.	Length (mm)	Operating force	Life	QTY per pack (Plastic bag)
INT-1129BM43A	4.3	200±50gf	100,000 Cycles Min.	2K
INT-1129BM50A	5.0			
INT-1129BM69A	6.9			
INT-1129BM70A	7.0			
INT-1129BM80A	8.0			
INT-1129BM43B	4.3	250±70gf		
INT-1129BM50B	5.0			
INT-1129BM69B	6.9			
INT-1129BM70B	7.0			
INT-1129BM80B	8.0			

Drawing :

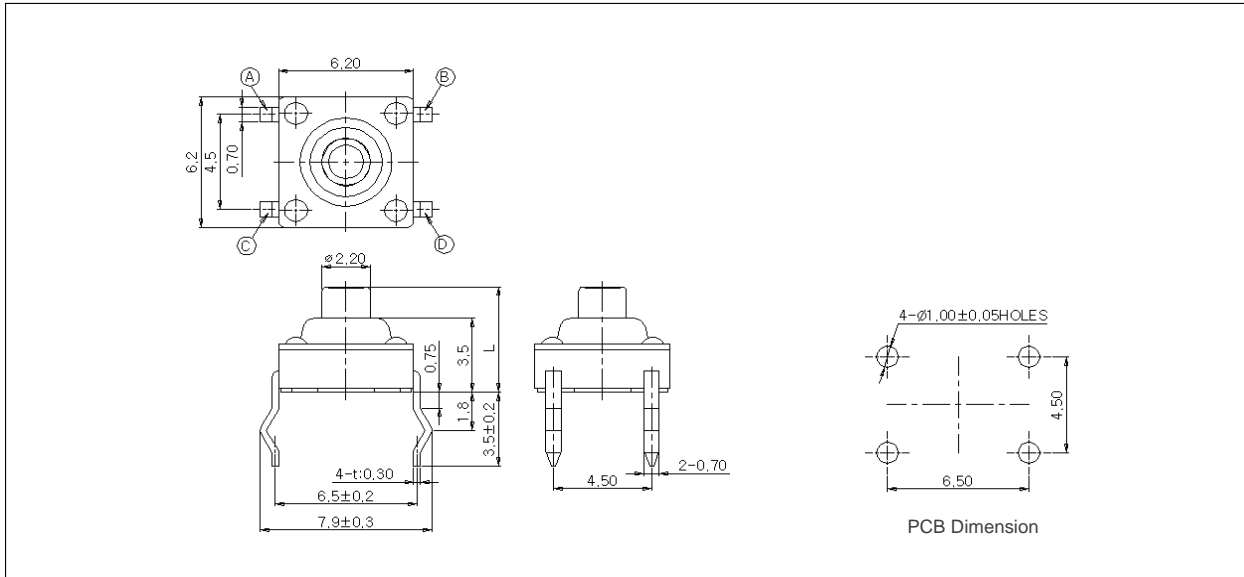

Circuit diagram :

