

Waterproof switches

INT-1108V Series

7.2x7.2mm, Through hole type, Side push

Features : IP67 dust & water resistance

Applications : Home appliances or Industrial equipments used around water

Specifications :

Rating	DC 12V 50mA
Contact resistance	100mΩ Max.
Travel (mm)	0.25±0.1



Model list :

Model No.	Length (mm)	Operating force	Life	QTY per pack (Plastic bag)
INT-1108V43A	3.65	230±40gf	100,000 Cycles Min.	2K
INT-1108V49A	4.33			
INT-1108V50A	4.45			
INT-1108V69A	6.25			
INT-1108V70A	6.45			
INT-1108V90A	8.4			
INT-1108V13A	12.4			
INT-1108V43B	3.65	250±70gf		
INT-1108V49B	4.33			
INT-1108V50B	4.45			
INT-1108V69B	6.25			
INT-1108V70B	6.45			
INT-1108V90B	8.4			
INT-1108V13B	12.4			

Drawing :

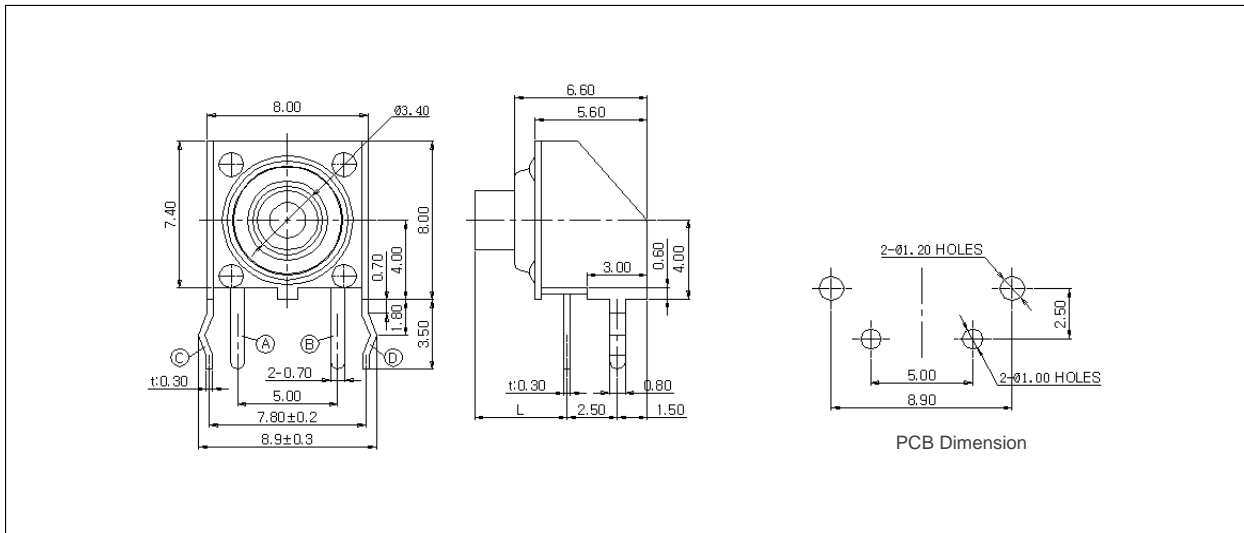

Waterproof switches

INT-1108V Series

7.2x7.2mm, Through hole type, Side push

Circuit diagram :

