

# Waterproof switches

## INT-1108BM Series

7.2x7.2mm, Metal cover, Through hole type

**Features :** IP67 dust & water resistance

**Applications :** Home appliances or Industrial equipments used around water



**Specifications :**

Rating	DC 12V 50mA
Contact resistance	100mΩ Max.
Travel (mm)	0.25±0.1

**Model list :**

Model No.	Length (mm)	Operating force	Life	QTY per pack (Plastic bag)
INT-1108BM43A	4.3	230±40gf	100,000 Cycles Min.	2K
INT-1108BM49A	4.98			
INT-1108BM50A	5.1			
INT-1108BM69A	6.9			
INT-1108BM70A	7.1			
INT-1108BM90A	9.0			
INT-1108BM13A	13.0			
INT-1108BM43B	4.3	250±70gf		
INT-1108BM49B	4.98			
INT-1108BM50B	5.1			
INT-1108BM69B	6.9			
INT-1108BM70B	7.1			
INT-1108BM90B	9.0			
INT-1108BM13B	13.0			

**Drawing :**

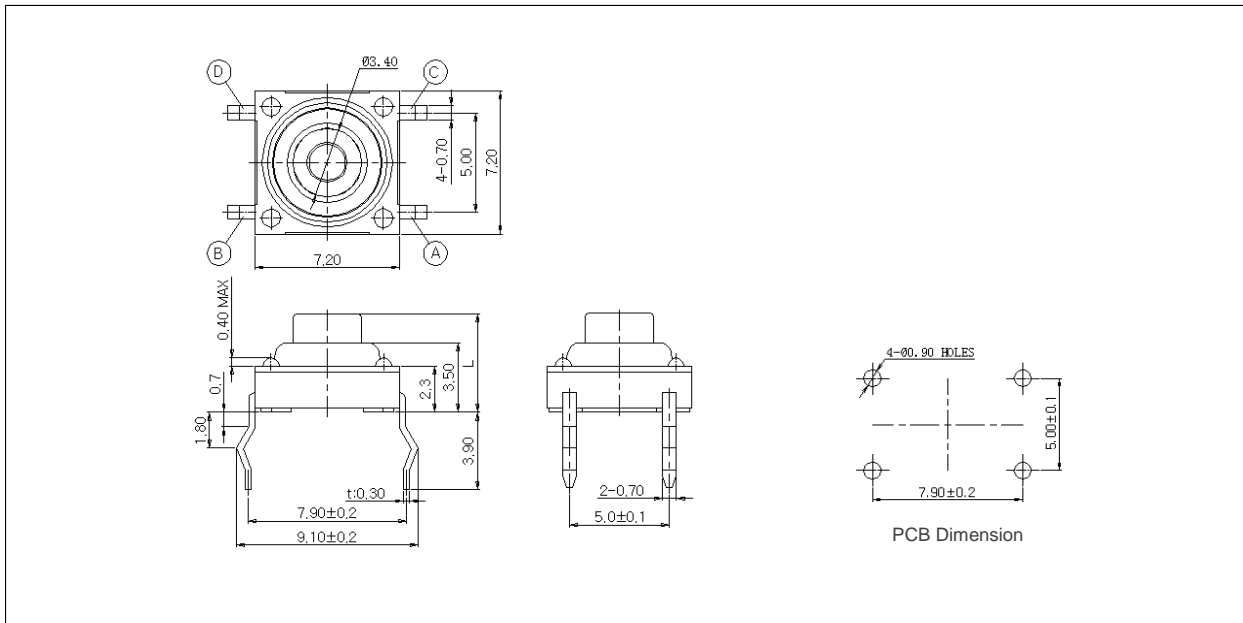

# Waterproof switches

## INT-1108BM Series

7.2x7.2mm, Metal cover, Through hole type

Circuit diagram :

