

Waterproof switches

INT-1108B Series

7.2x7.2mm, Through hole type

Features : IP67 dust & water resistance

Applications : Home appliances or Industrial equipments used around water

Specifications :

Rating	DC 12V 50mA
Contact resistance	100mΩ Max.
Travel (mm)	0.25±0.1

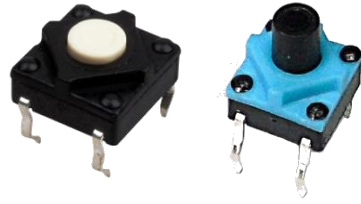

Black cover

Blue cover

Model list :

Model No.	Length (mm)	Operating force	Life	Cover color	QTY per pack (Plastic bag)
INT-1108B43A	4.3	230±40gf	100,000 Cycles Min.	Black	2K
INT-1108B49A	4.98				
INT-1108B50A	5.1				
INT-1108B69A	6.9				
INT-1108B70A	7.1				
INT-1108B90A	9.0				
INT-1108B13A	13.0				
INT-1108B43B	4.3	250±70gf		Black	
INT-1108B49B	4.98				
INT-1108B50B	5.1				
INT-1108B69B	6.9				
INT-1108B70B	7.1				
INT-1108B90B	9.0				
INT-1108B13B	13.0				

Drawing :

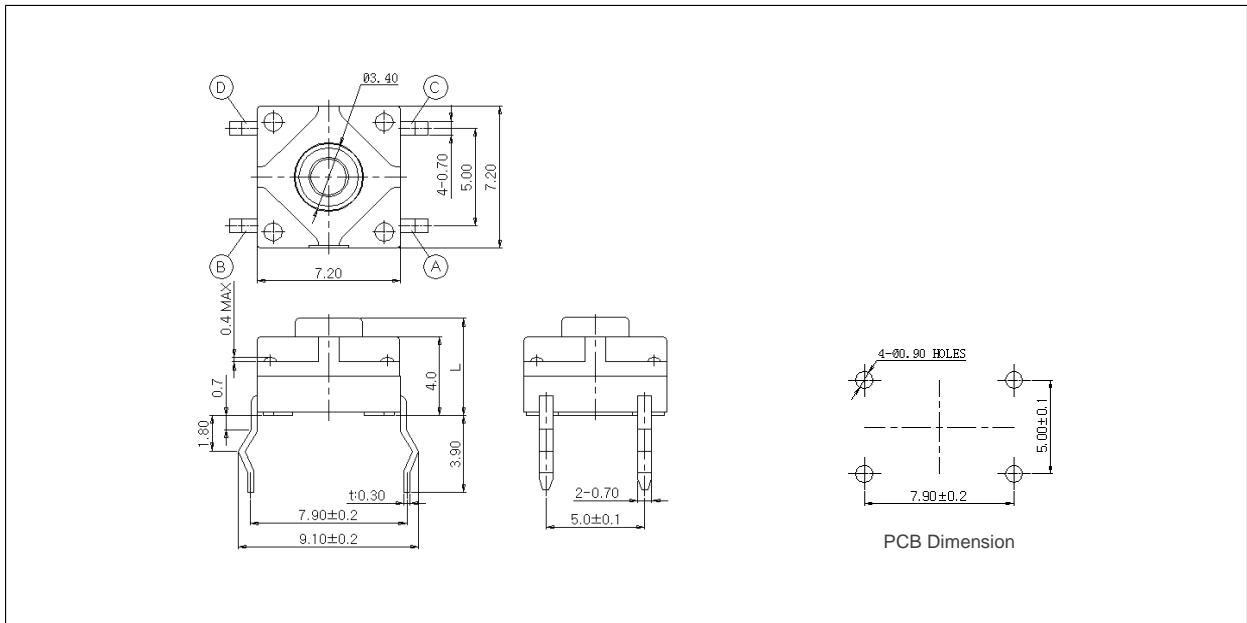

TACT
Switch

Waterproof switches

INT-1108B Series

7.2x7.2mm, Through hole type

Circuit diagram :

